

Strap Fastening Instructions:

1. Feed the long strap through the left heel slot, passing the strap between the spikes on the underside of the shoe, and then back up through the right heel slot. (Use slots according to shoe size)
2. Attach the slider with dome uppermost (see step 2).
3. Clip the 2nd half of buckle into its housing
4. Pass the strap under the buckle, up through slot 2 then down through slot 1.
5. To secure the strap, pass up through slot 3 of slider and down through slot 4.
6. Repeat for shorter front strap. (Use slots according to shoe size)
6. Adjust as necessary.
7. To unfasten, squeeze sides of buckle and release

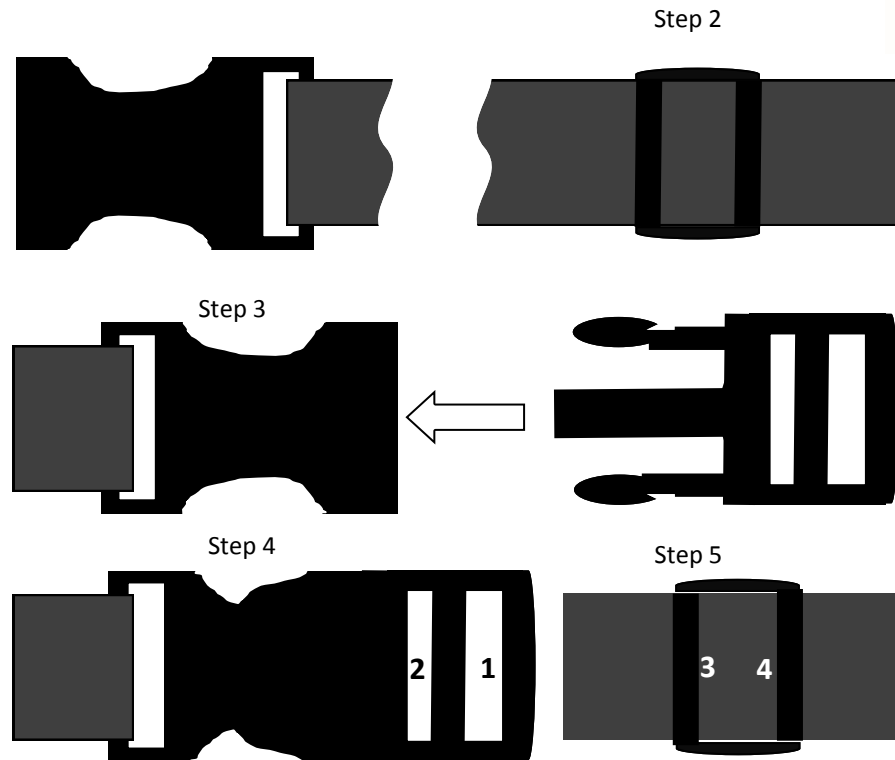

Assembly and General Use Instructions:

- Insert the 13 spikes into the prepared holes in each shoe. Secure the spikes with the nuts provided
- Attach the straps as detailed above
- Wear durable walking boots or shoes.
- USE WITH CARE in a pronounced walking fashion to ensure that the spikes penetrate the lawn surface and are removed vertically.
- Ensure the shoes are stored safely after use. Keep away from children and pets.
- Always check the spikes and straps are fastened securely before use.